

Main Advantages

- ▶ Adopt tubular positive plate
- ▶ Longest lifespan under deep discharge
- ▶ Strong temperature resistance performance
- ▶ Better charge reception capability
- ▶ 20 years design life



Specification	
Rated Voltage	2V
Nominal Capacity(C10,1.80V/cell)	600Ah (60A to 1.80V @25°C)
Terminal	M8 Φ=20
Approx. Weight	Approx. 45Kg (dry cell: 32Kg)
Container Material	SAN transparent container
Max. Discharge Current	5000A (5 sec)
Internal resistance(25°C)	Approx 0.41 mΩ (fully charged)
Operating temperature range	Discharge: -20°C~55°C Charge : -10°C~45°C Storage : -15°C~45°C
Self discharge	≤3%/month @ 25°C
Design life	20 years (floating design)
Cycle use	
Charging current	≤150A
Voltage	2.35-2.40V/cell
Temperature compensation	-5mV/ °C
Standby use	
Charging current	No limit
Voltage	2.23V/cell
Temperature compensation	-3mV/ °C

Dimension:145(L)×206(W)×646(H)×701(TH) Unit: mm

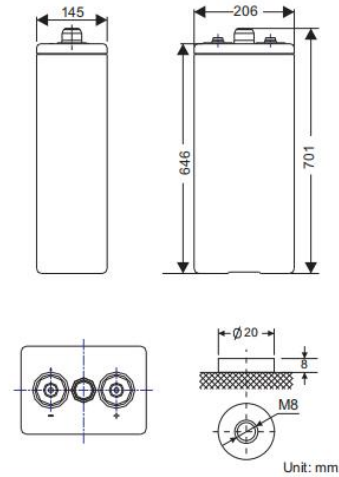

Rated Capacity(25°C)	
120 Hour Rate (7.10A to 1.85V)	852.0Ah
20 Hour Rate (37.23A to 1.8V)	744.6Ah
10 Hour Rate (63.38A to 1.8V)	633.8Ah
5 Hour Rate (108.2A to 1.75V)	541.0Ah
1 Hour Rate (363.5A to 1.60V)	363.5Ah

Constant Current Discharge Characteristics: A (25°C)

F.V/Time	30 min	1h	2h	3h	4h	5h	6h	8h	10h	24h	48h
1.60V	506	346	216	156	124	107	94	76.5	63.7	28.32	15.66
1.65V	489	338	212	153	123	106	93	76.0	63.3	28.32	15.54
1.70V	468	328	206	151	121	104	92	75.1	63.0	28.02	15.42
1.75V	451	318	201	147	119	103	90	73.7	62.1	27.54	15.24
1.80V	412	303	194	144	116	100	88	71.8	60.2	26.88	14.94
1.85V	366	282	183	140	113	97	85	69.8	59.4	26.04	14.22
1.95V	296	225	160	125	105	90	78	63.3	53.4	23.88	13.32

Constant Power Discharge Characteristics: W (25°C)

F.V/Time	30 min	1h	2h	3h	4h	5h	6h	8h	10h	24h	48h
1.60V	922	638	398	288	230	198	175	142.3	118.3	52.86	29.70
1.65V	899	624	390	284	227	196	173	141.2	117.8	52.74	29.58
1.70V	864	606	382	280	225	193	170	139.3	117.2	52.14	29.34
1.75V	834	592	374	274	221	191	168	137.5	116.1	51.72	29.22
1.80V	770	571	365	272	220	190	166	136.4	113.5	51.06	28.92
1.85V	696	534	349	267	216	186	163	133.9	114.1	50.46	28.08
1.95V	584	444	316	247	208	179	155	125.6	106.4	48.18	27.30

Disclaimer: Manufacturers have the right to self-modify the parameters of the product updates, please keep in touch with manufacturers to obtain the latest information.

Discharge Characteristics Curve

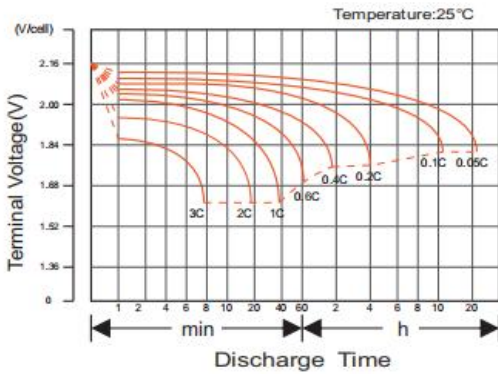

Charging Characteristics Curve

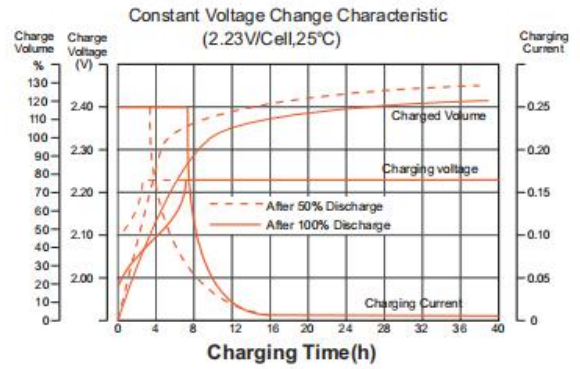

Cycle life of Different DOD

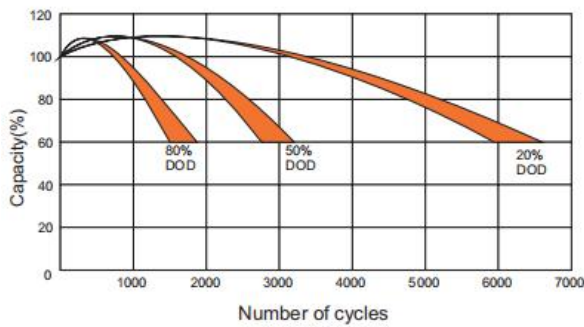

Temperature effects on capacity

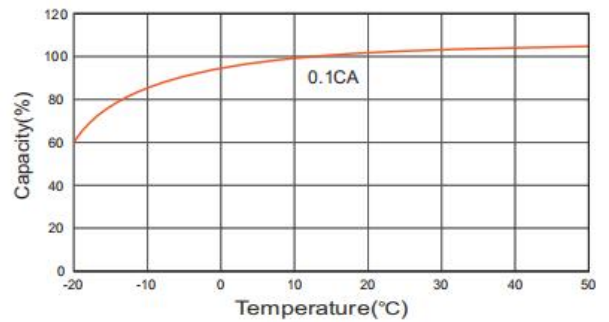

Charging voltage and temperature relationship

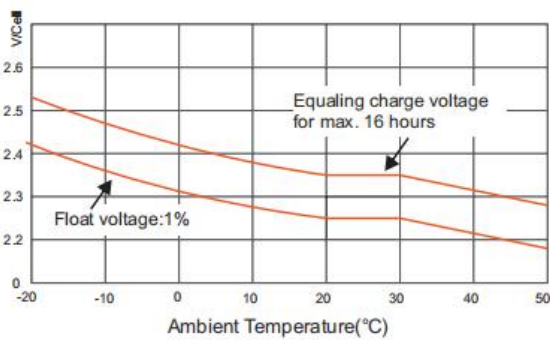

Self discharge Characteristics

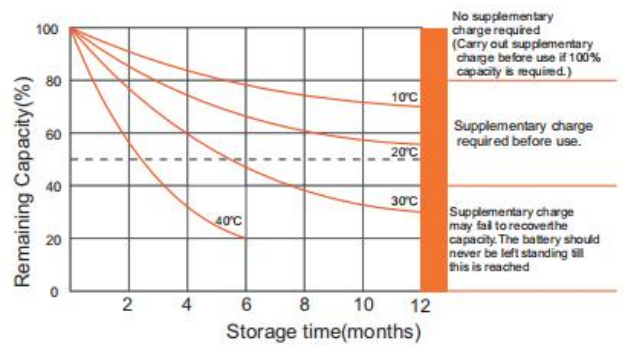

Temperature effects on floating life

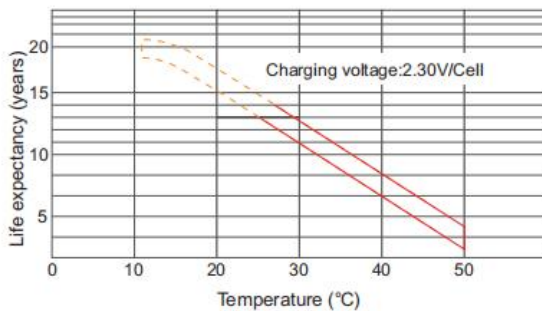

Life characteristics of standby use

